

POWER DISSIPATION MOUNT FIXED RESISTORS

Features

- Low inductance
- Safety flameproof construction
- Thin & lightweight body, saves the PCB space considerably



Dimension (mm)

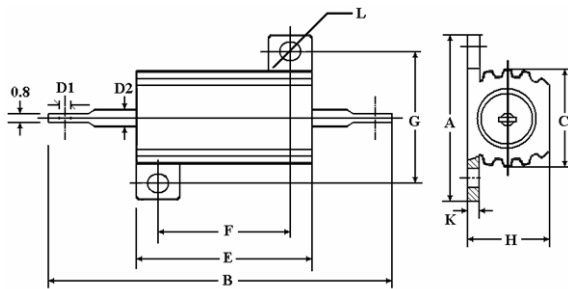

Derating Curve:

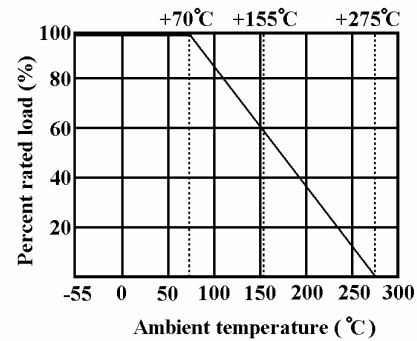

Style	Dimension (mm)										
	A Max.	B Max.	C	E Max.	F±0.5	G±0.5	H±1	K Max.	L±0.5	D1±0.5	D2±0.5
PDM 5W	16	30.2	8	15.5	11	12	4.4	2.5	2.2	1.5	1.5
PDM 10W	21	36.5	11	20	14	16	5	3.2	2.5	1.5	2
PDM 25W	27	51	14	28	18	20	7	3.2	3.5	2	2
PDM 50W	29	73	16.5	50	40	21.5	7.3	3.2	3.5	2	2

Style	Power Rating at 70°C	Resistance Range
PDM 5W	5W	5.1Ω ~ 1KΩ
PDM 10W	10W	5.1Ω ~ 1.5KΩ
PDM 25W	25W	5.1Ω ~ 8.2KΩ
PDM 50W	50W	5.1Ω ~ 20KΩ

Heat Rise Chart:

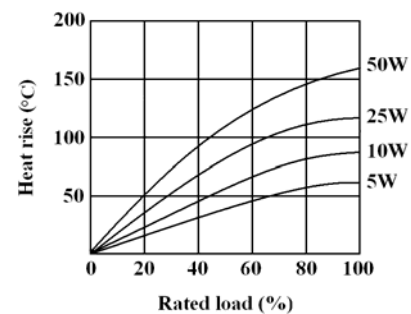

Performance Specifications

Temperature coefficient	< 20Ω: ±400PPM/°C; ≥ 20Ω: ±350PPM/°C
Short-time overload	ΔR/R ±(5.0% + 0.05Ω), with no evidence of mechanical damage.
Dielectric withstanding voltage	No evidence of flashover, mechanical damage, arcing or insulation breakdown.
Terminal strength	No evidence of mechanical damage.
Resistance to soldering heat	ΔR/R ±(1.0% + 0.05Ω), with no evidence of mechanical damage.
Solderability	Min. 95% coverage
Temperature cycling	ΔR/R ±(5.0% + 0.05Ω), with no evidence of mechanical damage.
Load life in humidity	For Wire-wound range: the ΔR/R is ±5%
Load life	For Wire-wound range: the ΔR/R is ±5%

* More details, please see pages 77-78.

*Ordering procedure is same as Cement Fixed Resistors (page 35)