

PRODUCT DATA



■ Radial Leaded Type KRT600 Series

● Features

1. Broadest range of resettable devices available in the industry
2. Current ratings from 0.15 to 0.16A
3. Maximum operating voltage is 60V, maximum interrupt voltage is 600V

● Recommended applications

1. Telecommunication
2. Network equipment

● Approvals



* UL 1434 recognized



* cUL recognized

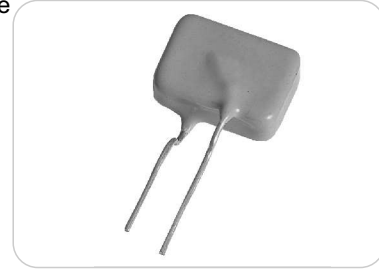

● Part number code

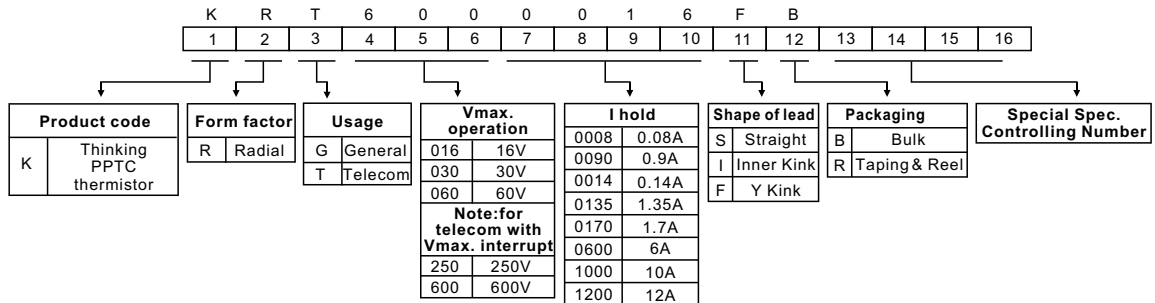

● Dimensions

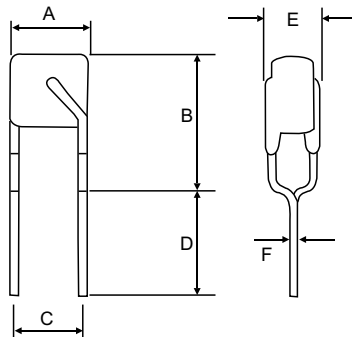

Marking: Device is marked Vmax. interrupt, I hold

(Unit: mm)

Part no.	A	B	C	D	E	F
	Max.	Max.	Typ.	Min.	Max.	Typ.
KRT6000015	13.5	13.6	5.0±0.8	4.7	6.0	0.65±0.02
KRT6000016	16.0	13.6	5.0±0.8	4.7	6.0	0.65±0.02

● **Characteristics**

Part no.	Vmax.	I _{max} .	I _{hold} @ 23°C	I _{trip} @ 23°C	V _{max} Interrupt	Pd (Max.)	Maximum time to trip		Resistance (Ω)		
	(V _{dc})	(A)	(A)	(A)	(V _{ac})	(W)	(A)	(Sec.)	Initial (R _i)		Post trip (R ₁)
									Min.	Max.	Max.
KRT6000015	60	3.0	0.150	0.300	600	1.00	1.00	5.00	6.00	12.00	22.00
KRT6000016	60	3.0	0.160	0.320	600	1.00	1.00	5.00	4.00	10.00	18.00

● **Average time to trip curve**

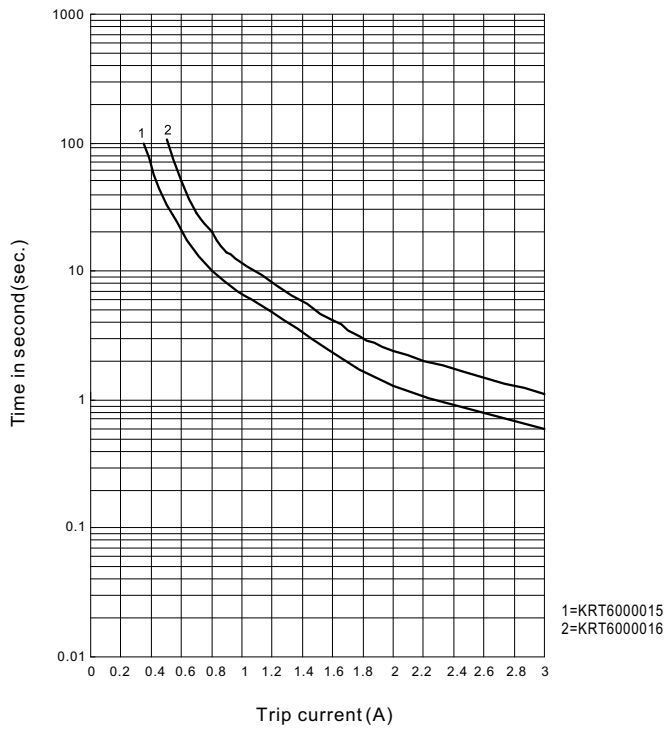

● **Thermal derating curve**

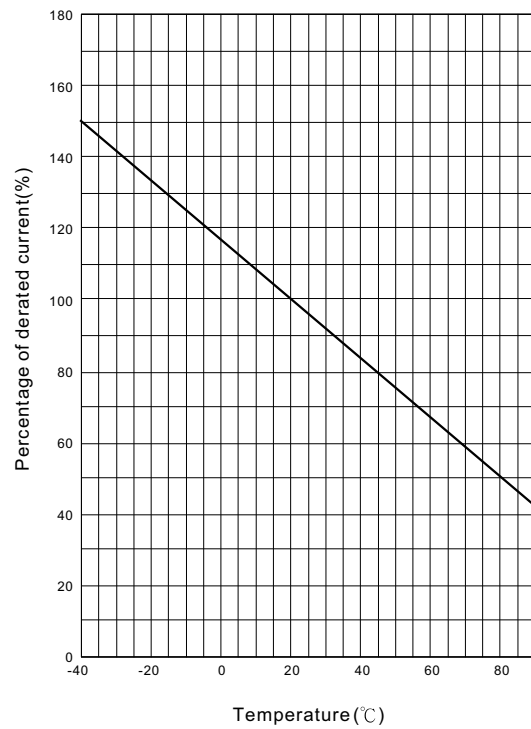

● **Reliability test**

Item	Test condition/methods	Criteria
Passive aging	85°C, 1000hrs	$\Delta R/R_i \leq \pm 5\%$
Humidity storage	40°C, 95%RH, 1344hrs Mil-Std 202, method 103 condition D	$\Delta R/R_i \leq \pm 5\%$
Thermal shock	85/-40°C, 20 cycles	$\Delta R/R_i \leq \pm 10\%$
Cycle life	50 cycles at a 120% maximum current (I _{max}) and maximum voltage (V _{max}). UL 1434	No damage
Trip endurance	V _{max} , I _{max} , 48Hrs	No damage
Steady-state operating life	V _{max} , I _{ss} , 1000hrs Mil-Std 750, method 1026	$\Delta R/R_i \leq \pm 10\%$